

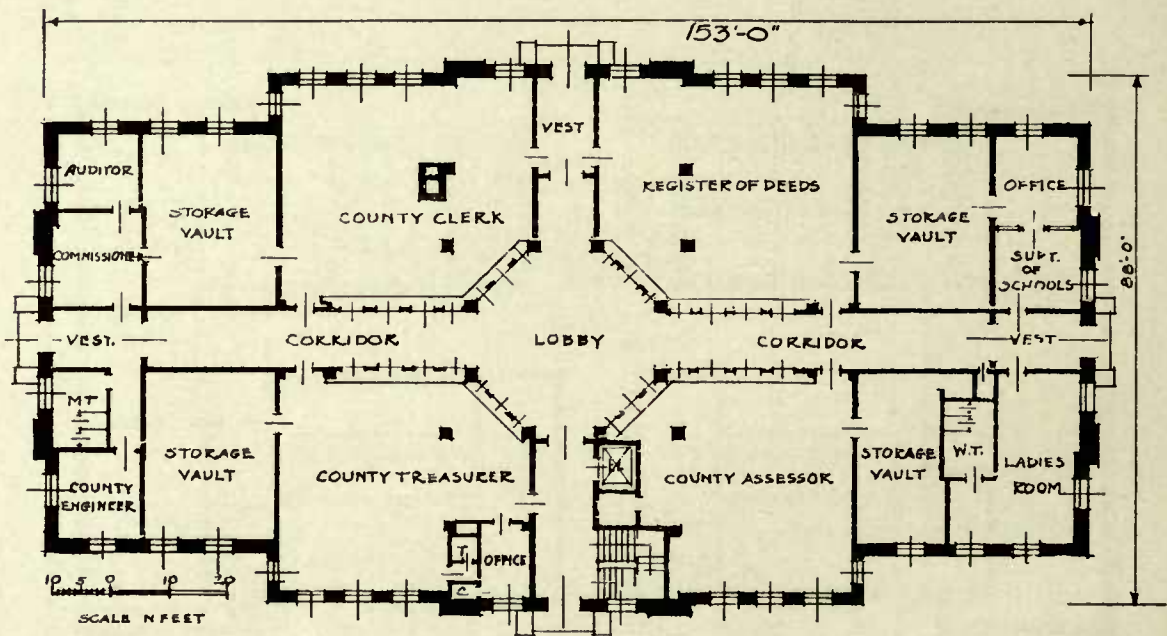

Garfield County Courthouse, *Enid, Oklahoma*



This new four-story and basement structure, with a partial fifth story, replaces an old courthouse which was destroyed by fire.

The basement contains offices for the justice of the peace, an assembly room, ladies' parlor, and the necessary utility rooms. The first floor is occupied by the offices of the county treasurer, clerk, assessor, recorder, county engineer, auditor, and superintendent of schools. The district and county

courtrooms, with offices for the judges, reporter, and attorneys, are on the second floor. The third floor contains the jury rooms and the upper parts of the courtrooms. The jail occupies the fourth and partial fifth floors.

The building is fireproof and is faced with limestone. It was completed in April 1935 at a construction cost of \$199,560 and a project cost of \$207,575.